

WHITELEY STREET

SIMPSON STREET

THORNTON STREET

GISBOURNE STREET

LEGEND

- Existing contour lines (refer others)
- Existing light towers (location TBC)
- Existing light towers to be relocated (location TBC)
- Proposed light towers (location TBC)
- Proposed trees
- Turf sports field
- Synthetic sports surface
- Hardcourt sports surface
- Turf
- Garden bed
- Coloured concrete
- Soft fall
- BBQ Shelter
- Picnic setting

SPORTING ACTIVITIES

MAIN FIELD

- Touch Football (x3)
- Junior Soccer (x1)
- AFL (x1)
- Cricket (x1)
- Athletics 400m (x1)
- Athletics 100m (x1)
- Rugby (x 1)

WESTERN FIELD (SYNTHETIC)

- Tennis & Netball courts (x3)
- Futsal fields (x3)
- Half Hockey field (x1)

WESTERN FIELD (HARDCOURTS)

- Tennis, Basketball & Netball courts (x3)

EASTERN FIELD

- Junior field (x1)
- Warm up area
- Field Events

FACILITIES BUILDING TO INCLUDE:

- Home / away change rooms
- Male / female / disabled toilets
- Canteen / kiosk & cool room
- Bar / function space
- Referee / officials room

FACILITIES BUILDING PRINCIPLES:

- Toilets easily accessible from all fields
- Canteen accessible from all fields
- Change rooms easily accessible from main field
- Referee / officials room to be able to view main field
- Bar / function space accessible from all fields and to have 'spill out' / outdoor
- BBQ area
- Clear site lines maintained to minimise 'undesirable' behaviour

KEY

- ① Main entry
- ② Club house courtyard & BBQ
- ③ Seating terrace
- ④ Exercise station
- ⑤ Playground
- ⑥ BBQ shelter
- ⑦ Storage for western field sports
- ⑧ Storage for main field sports
- ⑨ Grandstand
- ⑩ Service entry
- ⑪ Coach parking
- ⑫ Access ramp
- ⑬ Sports Lighting
- ⑭ Toilet
- ⑮ Signage
- ⑯ Scoreboard

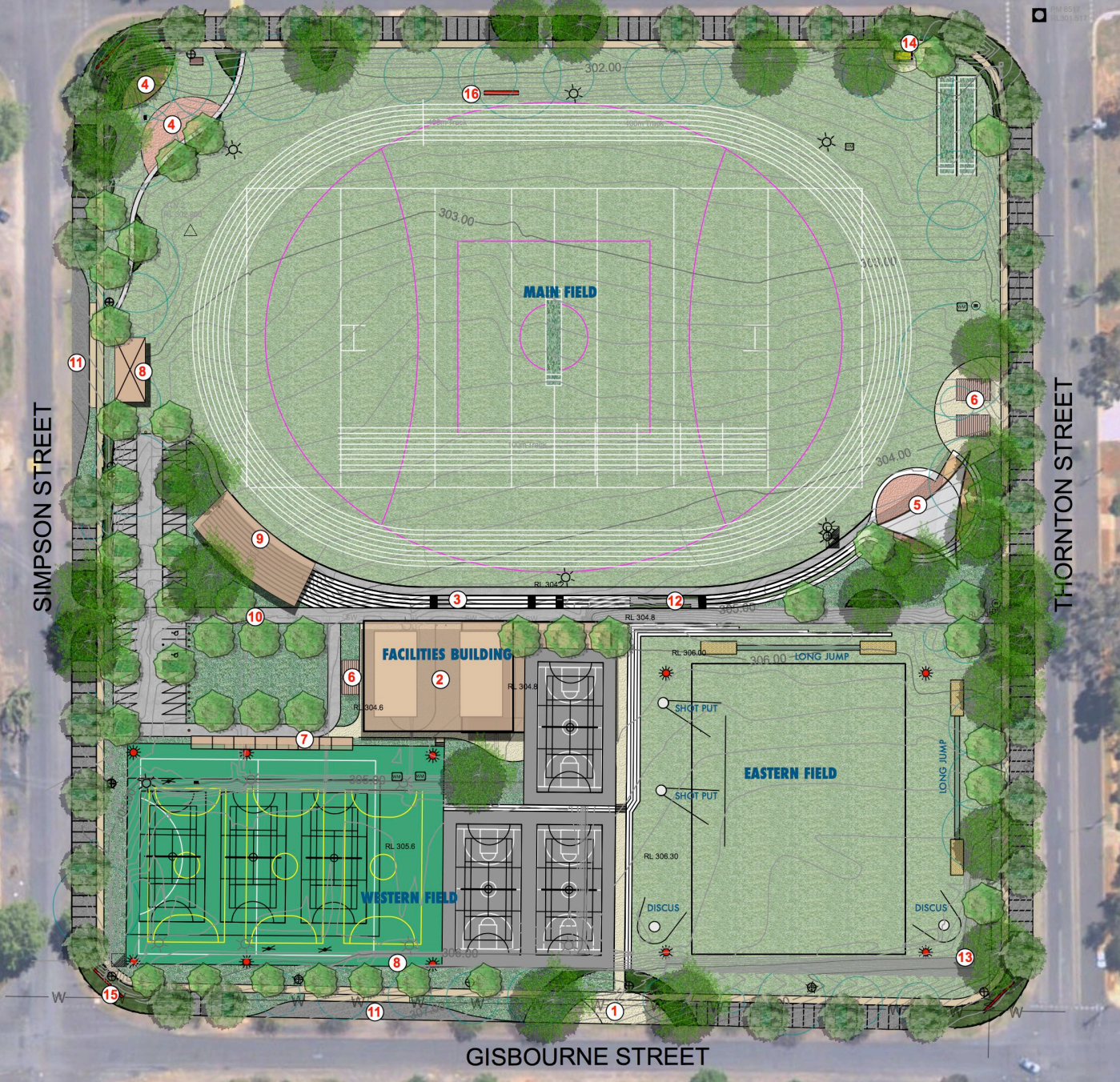

DESIGNED BY: DM	CHECKED BY: DM	SHEET No: LP06	SCALE: 1:500
DRAWN BY: CM	DATE: 08.11.17	PROJECT No: 0994	REVISION: REV D